

Canbat Bluetooth Quick Guide



- Phone needs Bluetooth 4.0 BLE
- Requires Android 4.3+
- Active Distance < 5.0m



- Supports iPhone 4S and Newer
- Requires iOS 6.0+
- Active Distance < 5.0m

Bluetooth lithium battery - Designed and developed in Canada - Keeping you in charge with smarter battery solutions

SEARCH & CONNECT

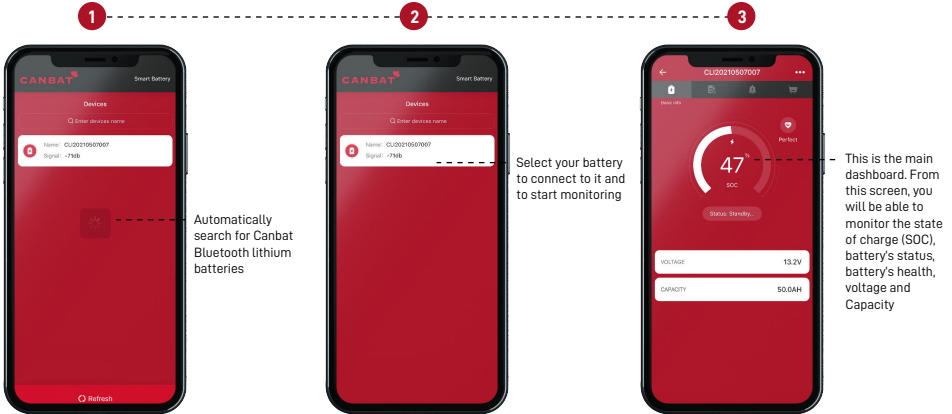

If you search and do not find your Canbat Bluetooth lithium battery in the search results, it may be because another device is already connected to it. Only one device can be connected at a time. For example, you can either connect the battery to your smartphone or your tablet, but not both simultaneously. This applies to iOS & Android.

SUMMARY



STATUS

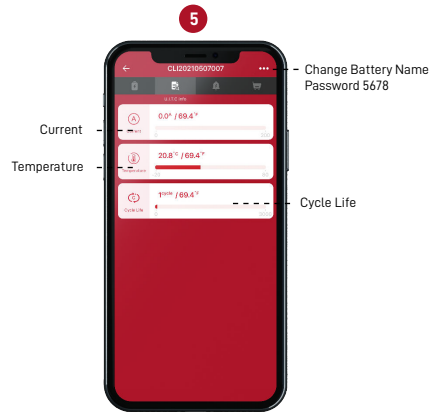

If the current is displaying a positive figure, it means the battery is charging. If the current is showing a negative figure, it means the battery is discharging. If the battery is charging and discharging simultaneously, the app will show the net current figure. For example, if the battery is charging at 5A and while discharging 7A, the app will show a net current of -2A. Battery's temperature is available in both celsius and fahrenheit. Cycles refers to the number of times the battery has been charged and discharged.

EVENTS

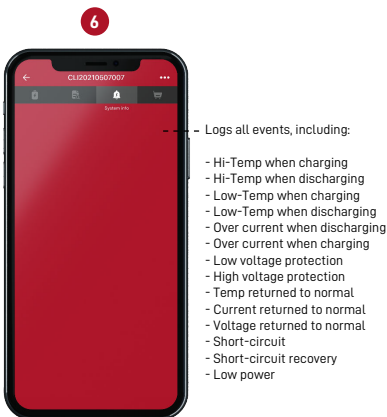

- Logs all events, including:
- Hi-Temp when charging
 - Hi-Temp when discharging
 - Low-Temp when charging
 - Low-Temp when discharging
 - Over current when discharging
 - Over current when charging
 - Low voltage protection
 - High voltage protection
 - Temp returned to normal
 - Current returned to normal
 - Voltage returned to normal
 - Short-circuit
 - Short-circuit recovery
 - Low power

TIPS

A new version of the Canbat app may be available at anytime without notice. Ensure you have the latest version app. If you already have the Canbat BT app, it may not update automatically. To ensure the latest version is installed, delete the existing app and download it again from the app store.

The Canbat BT app is designed for Canbat Bluetooth lithium batteries only. The app will not connect to other devices, such as Canbat WiFi batteries. There is a separate app for those batteries.

You can only connect a Bluetooth lithium battery to one device at a time, such as to your smartphone or to your tablet, but not both simultaneously.

Feel free to contact us anytime if you have any questions. We are always happy to help!